

# TAB

Video door entry systems:  
the new dimension



**ELVAX**



We have added by taking away.  
Slimmer, more compact, easier:  
the TAB range has grown.

First of all, take a look. Before you read about all the technology and aesthetic decisions behind it. Take a look, because even at a glance the video door entry systems TAB, TAB Free and the door entry phone TAB jr. represent a true innovation. Capacitive keypad, ultra-thin design that is contemporary, elegant and discreet at the same time. And if you add easy installation and the guarantees offered by a company that has been a leader in the video door entry industry for over 50 years, it will be impossible to look anywhere else.



# TAB Free the hands-free video door entry system.

The new TAB Free speakerphone video door entry unit embraces all the technological and style features of the TAB range, with an extra dash of practicality. Because in addition to the ultra-thin, contemporary design, capacitive keypad and colour display you'll have the pleasure of communicating freely, without using the handset.



EDVox



1

2

3

4

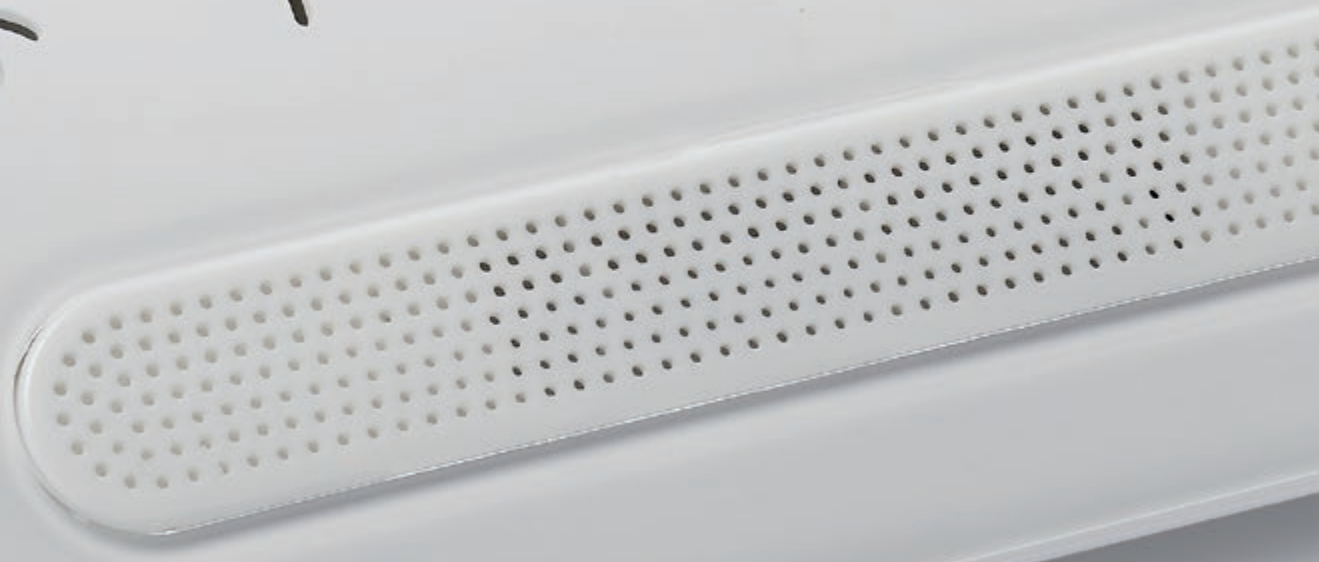

# The TAB range is now complete: closer and closer to your desires.

Lots of features are common to all models for a range designed to suit every need.

**TAB Free.**  
Freedom of voice.



## Modern appeal.

Simple but not square,  
minimal but not severe.  
One of a kind.

Inspired by the light and understated aesthetic so characteristic of the very latest technological devices, Tab video door entry systems are compact, with soft lines that diminish corners and melt into a smooth surface.

## Soft profile.

Everything outside the walls of your home is contained within a thickness of just 2.6 cm.

Inspired by optimum slimness: the device is simply placed on a wall fixing bracket to create a subtle "suspended" effect that emphasises its design and finish, as well as its ultra-thin profile, just 2.6 cm.

**TAB.**  
Evolved  
communication.



## TAB jr.

For the most basic requirements.

Smaller by name and by nature: Tab junior is the little brother of Tab, designed for anyone who does not require the video function. It is an audio door entry unit offering the same technology, quality, design and standard functions of the “bigger” version.

# Black&White.

Integral colours, glass-effect surfaces.  
For a look to suit any interior design scheme.

Bright white or tempting black: these two classic and elegant timeless colours blend perfectly into any domestic environment. And, thanks to the special glass effect, the video and audio door entry systems acquire an even more pure and stylish appearance.





# Colour display.

Charming from every angle.

The world outside the walls of your home has never been so bright and beautiful. A 3.5" display frames a high definition image of whoever is ringing your doorbell and asking your permission to enter.



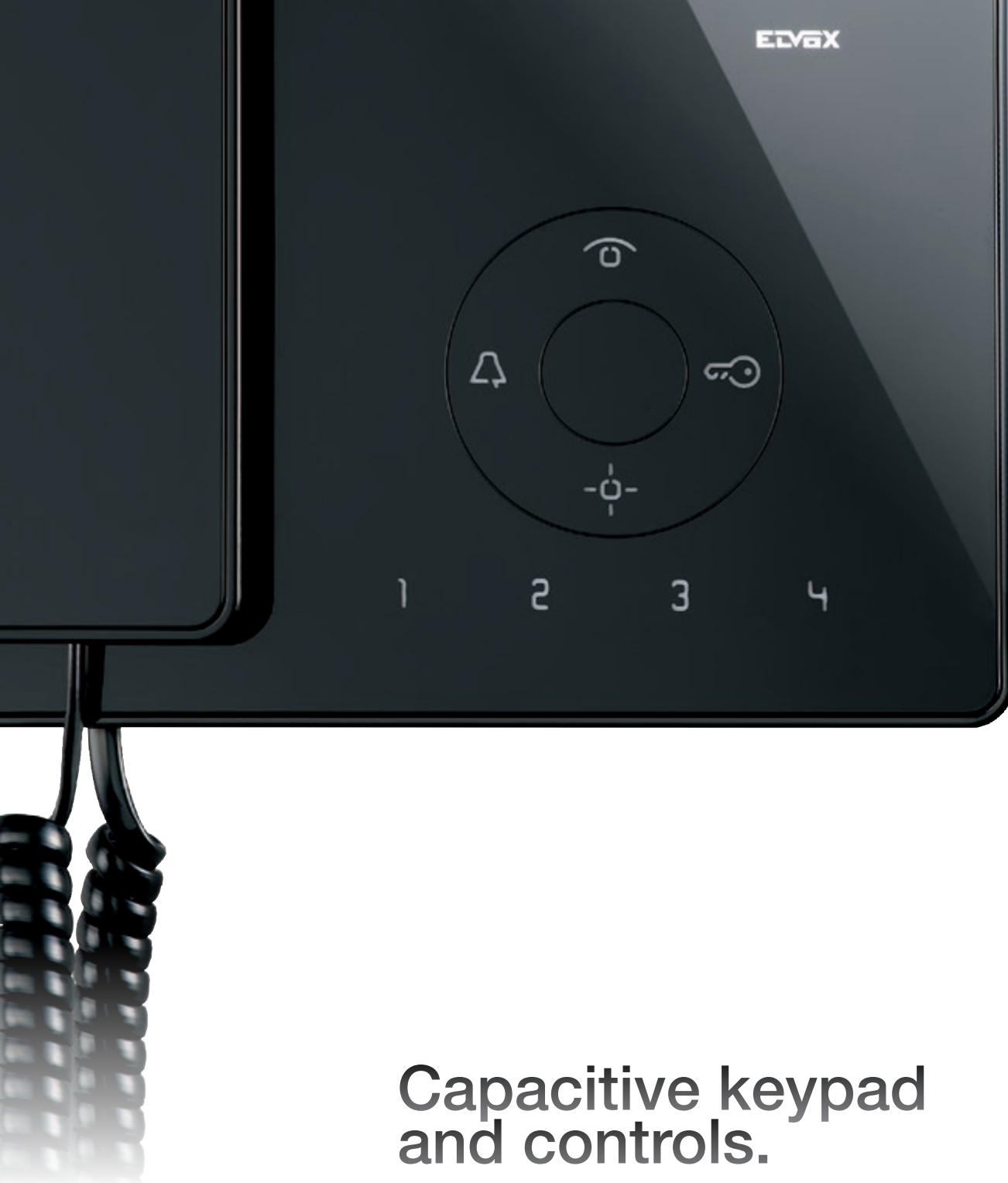

## Capacitive keypad and controls.

A smooth-to-the-touch surface camouflages innovative technology, the first of its kind applied in this sector.

Communicating with the outside world becomes a multi-sensory experience: your finger slides across a smooth surface in search of a keypad that does not exist. The eye sees the icons indicating each function. The ear hears the crystal clear sound confirming that your command has been carried out successfully. And a light touch allows you to set the volume perfectly, with the user-friendly settings.

# Function programming.

TAB speaks clearly: you will understand perfectly straight away.

One function to open the lock, one function to mute the ringtone during a call, and even more functions for video door entry unit self-start and stair lighting activation. There are also 4 push buttons that can be programmed for intercom calls or auxiliary services. And the language used is iconographic: clear, simple and back-lit so that you know when your command has been carried out successfully.

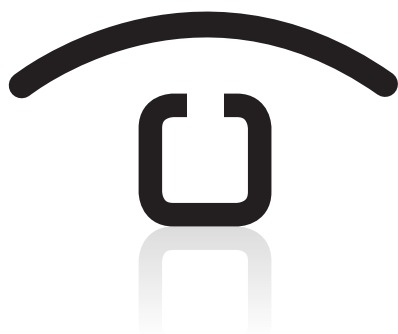

# Close-up view.

Details that make the difference.



## Profile

The thinnest on the market, just 2.6 cm thick. And thanks to the fixing bracket, it is easily applied to the wall.



## Design

Available in white or black: both versions are finished with a special glossy effect typical of today's ultra-modern technology, like an iPhone or iPad.



## Ringtone

10 different pre-set melodies: simply select your favourite and adjust the volume according to your requirements and the application contexts.

**3,5"**

## Colour display

Visual performance embodied in a 3.5" display showing external images with perfect colour and definition.





1 2 3 4



## Capacitive keypad

Capacitive technology the TAB video door entry units are the first to be fitted with flush-mounted buttons and controls. There is no extra bulk, in line with the minimal design of the appliance as a whole. 8 functions 4 standard and 4 programmable for intercom calls or auxiliary services.



## Accessibility

TAB video door entry units are suitable for use also by hearing aid wearers.

Plus, the keypad is back-lit: each icon lights up when the corresponding function is activated.



## Speakerphone

TAB Free means freedom of communication, with no ties, totally practical. No cables, no handsets.



## Side controls

In TAB Free the controls to increase or decrease the volume are user-friendly. Positioned on the side for easier use

# Due Fili Plus technology

A single cable connects thousands of users:  
now that's communication!



Rapid installation, precision and flexibility: the founding principles of the Elvox Due Fili Plus technology. Digital signals are transmitted by a thin non-polarised two-wire cable. This makes setting up the wiring for the power supply, Audio-Video signal and all system transmission quicker and easier. Entrance panels, power supplies, any distributors and devices communicate perfectly with each other, for systems that manage up to 484 external and 6,400 internal panels.



## Installation made easy.

Done in an instant, even in existing systems.

TAB video and audio door entry systems come with a fixing bracket for surface mounting, and can be installed easily in any residential space, whether a new build or a renovation. In addition, the fixing bracket also offers flush mounting in conjunction with 3-module mounting boxes such as V71303 or 60/70 mm round mounting boxes.

TAB also offers easy replacement in existing systems, as it is equipped with Due Fili Plus technology. For example, in residential complexes using different devices or earlier versions, TAB can be installed quickly and easily in any homes that are renovated, while keeping the video door entry units and entrance panels installed previously in the other homes.



## Catalogue section

---



---

**SPEAKERPHONE TAB FREE  
VIDEO DOOR ENTRY UNIT**

from page 16

---

**TAB VIDEO DOOR ENTRY UNIT**

from page 18

---

**TAB JR. INTERPHONES**

from page 20

---

**SYSTEM COMPONENTS**

from page 22

---

**INSTALLATION EXAMPLES**

from page 28

---

# Video door entry systems

## Tab Free video door entry unit

### Speakerphone Tab Free video door entry unit for Due Fili Plus system

Speakerphone video door entry unit made of thermoplastic material with 3.5" LCD colour display. Equipped with keypad for the main video door entry functions: speak/listen, door lock release, selfstart, auxiliary services (stair lighting), ringtone muting and 4 programmable additional buttons that can execute up to 4 auxiliary functions or intercommunicating calls.

It is possible to control: brightness, ringtone volume and muting when "User Away" function is activated. Possibility of ringtone type selection for calls made from different points, e.g.: outdoor entrance panel, landing call, intercom call.

LED signalling of "door/gate open" and "Unanswered calls" (up to 4 calls with video door entry unit in ringtone muted mode).

For use in Elvox Due Fili Plus systems with power supply 6922 or 6922.1.

The speakerphone video door unit is provided of the functions for hearing aid wearers.

### Conformity to standards

EMC Directive

### Main technical specifications

- Due Fili Plus Bus power supply.
- 3.5" LCD display.
- Video door entry unit made of ABS with mirror gloss finish on front panel.
- Touch-sensitive keypad with backlit symbols (during operation).
- Electronic ringtone: with diversification between 10 different melodies signalling entrance panel calls, intercom calls and landing calls.
- Input for landing call.
- Designed for surface mounting with metallic baseplate or fitting in a box (can be mounted directly onto the wall using wall plugs or to a 3-module flush mounting box or Ø 60 mm round flush mounting box or 56x56 mm flush mounting box).
- Video door entry unit dimensions: 131x150x26,5 mm.
- The video door entry unit can coexist with other units from other series and can be used also with entrance panels of Due Fili Plus system.

### Technical data

#### Inputs

power supply from Bus	28 Vdc rated voltage
absorption stand-by	10 mA
max absorption operation	160 mA
operating temperature	0° to +40° C

### Adjustments and connections

A) Side adjustment of the volume.

B) Side adjustment of the brightness.

C) Terminal block for video door entry unit connection: to the Due Fili Plus system and to an external push button for landing calls.

### Touch-sensitive keypad and indicator light signalling



Speak/listen button.



Self-start push button.



Lock opening push button.



Auxiliary 1 (Stair light): for auxiliary service.



Ringtone mute push button and signalling of:

- (flashing light) incoming call from outdoor entrance panel or intercom device.
- (steady light) ringtone muted.
- (steady light that flashes every 10s, while the ringtone is muted) calls have been made from the entrance panel.

1 2 3 4

Programmable push buttons for activating auxiliary services or intercom calls.

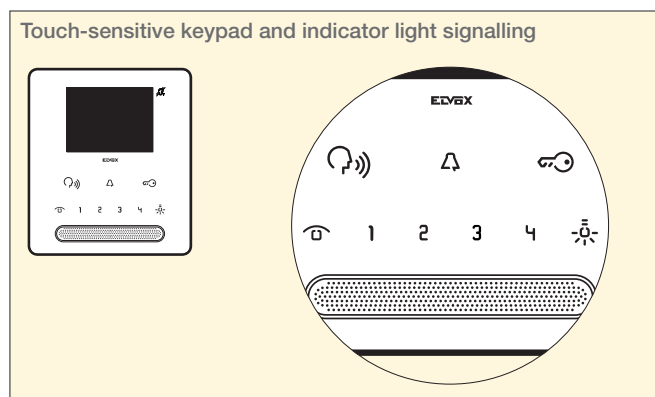
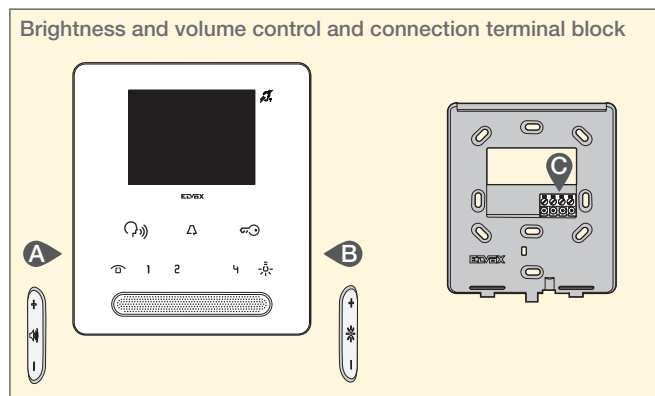

# Video door entry systems

## Tab Free video door entry unit

### Video door entry units

- ▲ 7539 /04 Surface mounting speakerphone Tab Free video door entry unit for Due Fili Plus system with 3.5" colour LCD display, touch-sensitive keypad for interphone functions and intercom calls, bracket for fixing in round or rectangular mounting box



▲ 7539  
white



▲ 7539/04  
black

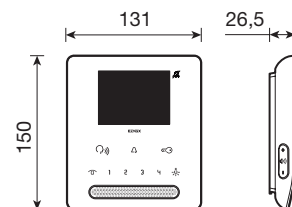

### Accessories - Tab Free series video door entry units

- ▲ 753V Table box for Tab and Tab Free video door entry units, with 2 m of cable and pullout socket and plug

### Video door entry system kit

- ▲ 7539/M Due Fili Plus speakerphone video door entry kit, containing: 1x13K1 audio/video entrance panel, 1 x R131 button, 1 x 13F2 electronic unit, 1 x 7539 Tab Free speakerphone unit, white and 1 x 6922 power supply unit
- ▲ 7539/K Due Fili Plus speakerphone video door entry kit, containing: 1x1321 audio/video entrance panel, 1 x 9192 flush mounting box, 1 x 13F5 electronic unit, 1 x 7539 Tab Free speakerphone unit, white and 1 x 6922 power supply unit



▲ 7539/M



▲ 7539/K

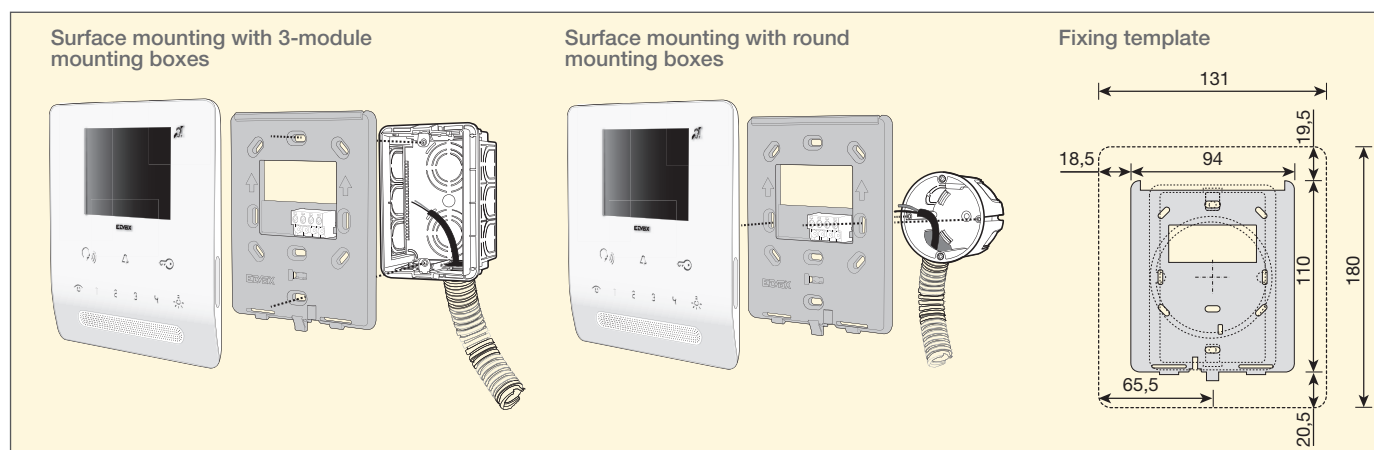

# Video door entry systems

## Tab video door entry unit

### Tab video door entry unit for Due Fili Plus systems

Video door entry unit made of thermoplastic material with handset and 3.5" LCD colour display. Equipped with four buttons for the main video door entry functions: door lock release, self-start, auxiliary services (stair lighting), ringtone muting and 4 programmable additional buttons that can execute up to 4 auxiliary functions or intercommunicating calls.

It is possible to control ringtone volume and muting when "User Away" function is activated. Possibility of ringtone type selection for calls made from different points, e.g.: outdoor entrance panel, landing call, intercom call.

LED signalling of "door/gate open" and "Unanswered calls" (up to 4 calls with video door entry unit in ringtone muted mode).

For use in Elvox Due Fili Plus systems with power supply 6922 or 6922.1.

Products 7529/D and 7529/D04 are equipped with a function for hearing aid wearers.

### Conformity to standards

EMC Directive

### Main technical specifications

- Due Fili Plus Bus power supply.
- Input for additional power supply (6923), allowing simultaneous start-up of more than two internal units.
- 3.5" LCD display.

- Video door entry unit made of ABS with mirror gloss finish on front panel.
- Touch-sensitive keypad with backlit symbols (during operation).
- Electronic ringtone: with diversification between 10 different melodies signalling entrance panel calls, intercom calls and landing calls.
- Input for landing call.
- Output for additional ringtone 860A or relay 0170/101.
- Designed for surface mounting with metallic baseplate or fitting in a box (can be mounted directly onto the wall using wall plugs or to a 3-module flush mounting box or Ø 60 or 70 mm round flush mounting box).
- Video door entry unit dimensions with hooked handset: 160x180x45 mm.
- The video door entry unit can coexist with other units from other series and can be used also with entrance panels of Due Fili Plus system.

### Technical data

#### Inputs

power supply from Bus	28 Vdc rated voltage
absorption stand-by	10 mA
max absorption operation	200 mA
operating temperature	0° to +40° C
additional power supply	with 6923

Option of using additional power supply 6923 where necessary (Bus voltage at monitor terminals 1 and 2 registering < 24 V d.c.)

### Adjustments and connections

- A) Brightness adjustment.
- B) Contrast adjustment.
- C) Colour saturation adjustment.
- D) Terminal block for video door entry unit connection: to the Due Fili Plus system, to any additional power supply, to an additional external bell and to an external push button for landing calls.

### Touch-sensitive keypad and indicator light signalling



Self-start push button.



Ringtone mute push button and signalling of:

- (flashing light) incoming call from outdoor entrance panel or intercom device.
- (steady light) ringtone muted.
- (steady light that flashes every 10s, while the ringtone is muted) calls have been made from the entrance panel.



Lock opening push button.

- (steady light) indicates that the door is open.



Auxiliary 1 (Stair light): for auxiliary service.



Programmable push buttons for activating auxiliary services or intercom calls.

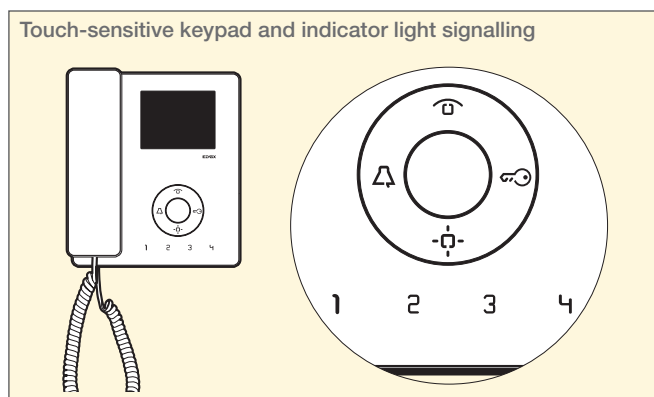
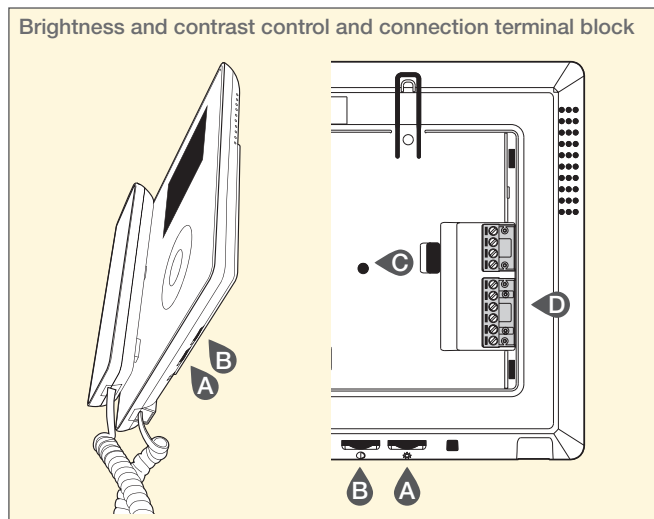

# Video door entry systems



## Tab video door entry unit

### Video door entry units

7529	/04	Surface mounting Tab video door entry unit for Due Fili Plus system with 3.5" colour display, handset, loudspeaker for electronic calls, touch-sensitive keypad for interphone functions and intercom calls, bracket for fixing in round or rectangular mounting box
7529/D	04	As above, with function for hearing aid wearers

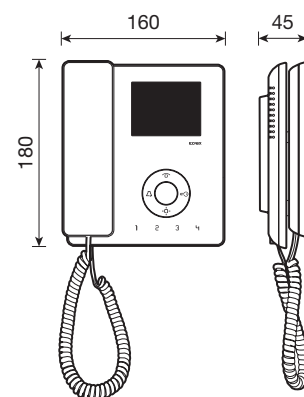

### Accessories - Tab series video door entry units

▲ 753V	Table box for Tab and Tab Free video door entry units, with 2 m of cable and pullout socket and plug
▲ 753S	Mounting box for Tab video door entry unit

### Video door entry system kit

▲ 7529/M	Due Fili Plus video door entry kit, containing: 1x13K1 audio/video entrance panel, 1 x R131 button, 1 x 13F2 electronic unit, 1 x 7529 Tab video door entry unit, white and 1 x 6922 power supply unit
7529/K	Due Fili Plus video door entry kit, containing: 1x1321 entrance panel, 1 x 9192 flush mounting box, 1 x 13F5 electronic unit, 1 x 7529 Tab video door entry unit, white and 1 x 6922 power supply unit

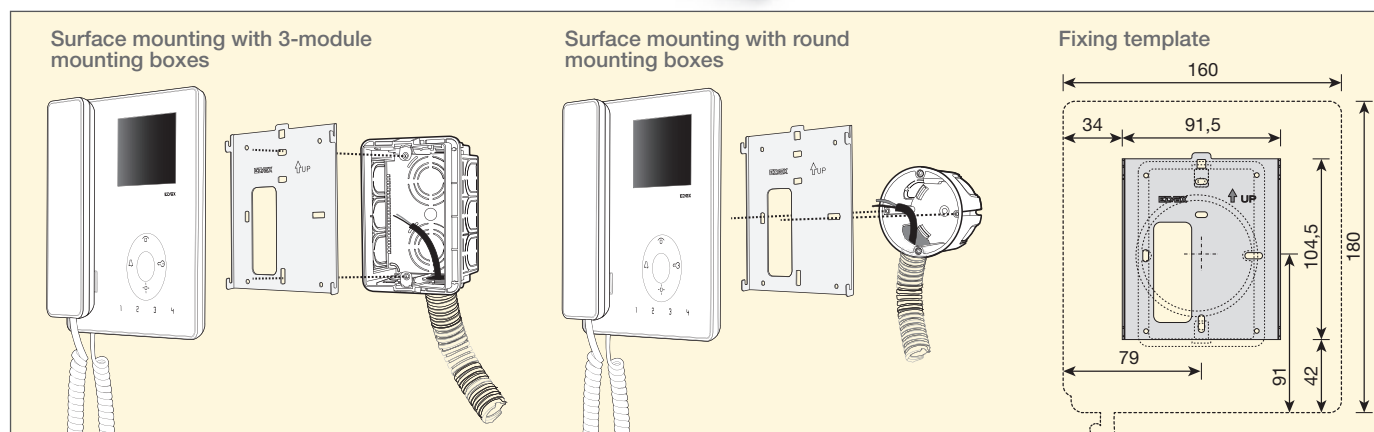

# Video door entry systems

## Tab jr. interphones

### Tab jr. interphone for Due Fili Plus systems

Interphone made of thermoplastic material with handset. Equipped with four buttons for the main video door entry functions: door lock release, self-start, auxiliary services (stair lighting), ringtone muting and 4 programmable additional buttons that can execute up to 4 auxiliary functions or intercommunicating calls.

It is possible to control ringtone volume and muting when "User Away" function is activated. Possibility of ringtone type selection for calls made from different points, e.g.: outdoor entrance panel, landing call, intercom call.

LED signalling of "door/gate open" and "Unanswered calls" (up to 4 calls with interphone in ringtone muted mode).

For use in Due Fili Plus systems with power supply 6922 or 6922.1.

Products 7509/D and 7509/D04 are equipped with a function for hearing aid wearers.

### Conformity to standards

EMC Directive

### Main technical specifications

- Due Fili Plus Bus power supply
- Interphone made of ABS with mirror gloss finish on front panel.
- Touch-sensitive keypad.
- Electronic ringtone: with diversification between 10 different melodies signalling entrance panel calls, intercom calls and landing calls.
- Output for additional ringtone art. 860A or relay art. 0170/101.
- Designed for surface mounting or fitting in a box (can be mounted directly onto the wall using wall plugs or to a 3-module flush mounting box or a Ø 60 or 70 mm round flush mounting box).
- Interphone dimensions with hooked handset: 105x180x35 mm.
- The interphone can coexist with audio and other units from other series and can be used also with entrance panels of Due Fili Plus system.

### Technical data

#### Inputs

power supply from Bus	28 Vdc rated voltage
absorption stand-by	10 mA
max absorption operation	100 mA
operating temperature	0° to +40° C

### Connections

A) Terminal block for interphone connection: to the Due Fili Plus system, to an additional external bell and to an external push button for landing calls.

### Touch-sensitive keypad and indicator light signalling



Self-start push button.



Ringtone muting push button.



Lock opening push button.



Auxiliary 1 (Stair light): for auxiliary service.

1 2 3 4

Programmable push buttons for activating auxiliary services or intercom calls.



Signalling during normal operation:

- (flashing light) incoming call from outdoor entrance panel or intercom device.
- (steady light) ringtone muted.
- (steady light that flashes every 10s, while the ringtone is muted) calls have been made from the entrance panel.



Signalling during normal operation:

- (steady light) indicates that the door is open.

### Connection terminal block

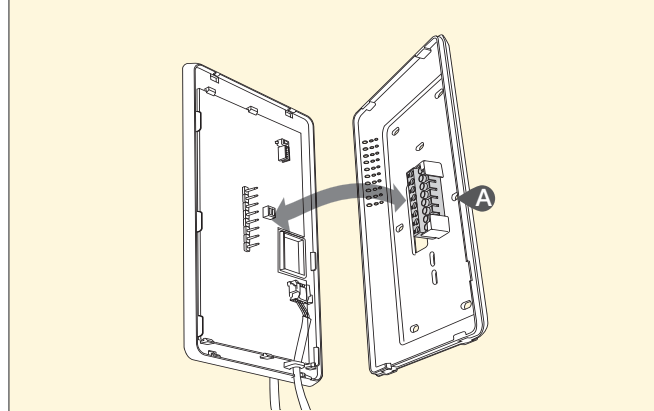

### Touch-sensitive keypad and indicator light signalling

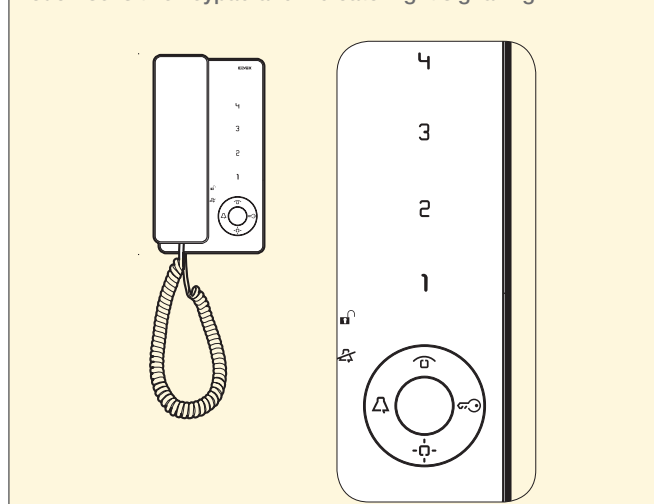

# Video door entry systems



## Tab jr. interphones

### Interphones

7509	/04	Surface mounting Tab jr. interphone for Due Fili Plus system with handset, loudspeaker for electronic calls, touch-sensitive keypad for interphone functions and intercom calls, screws for fixing in round or rectangular mounting box
7509/D	04	As above, with function for hearing aid wearers

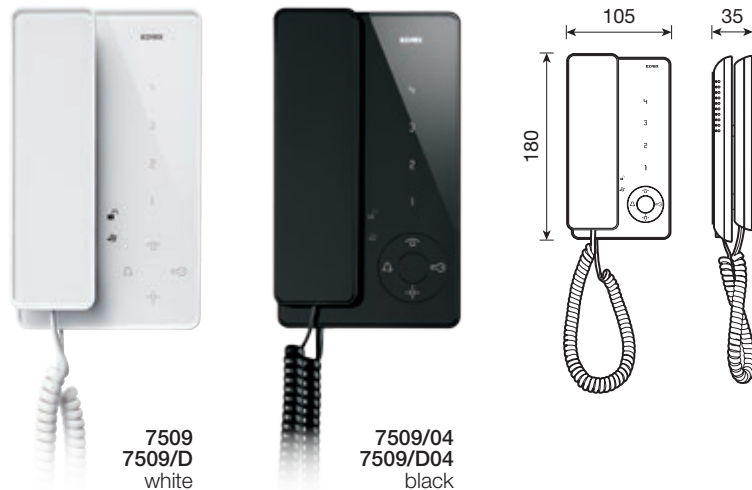

7509  
7509/D  
white

7509/04  
7509/D04  
black

### Accessories - Tab series audio door entry units

▲ 753A	Table box for Tab jr. interphone, with 2 m of cable and pullout socket and plug
--------	---

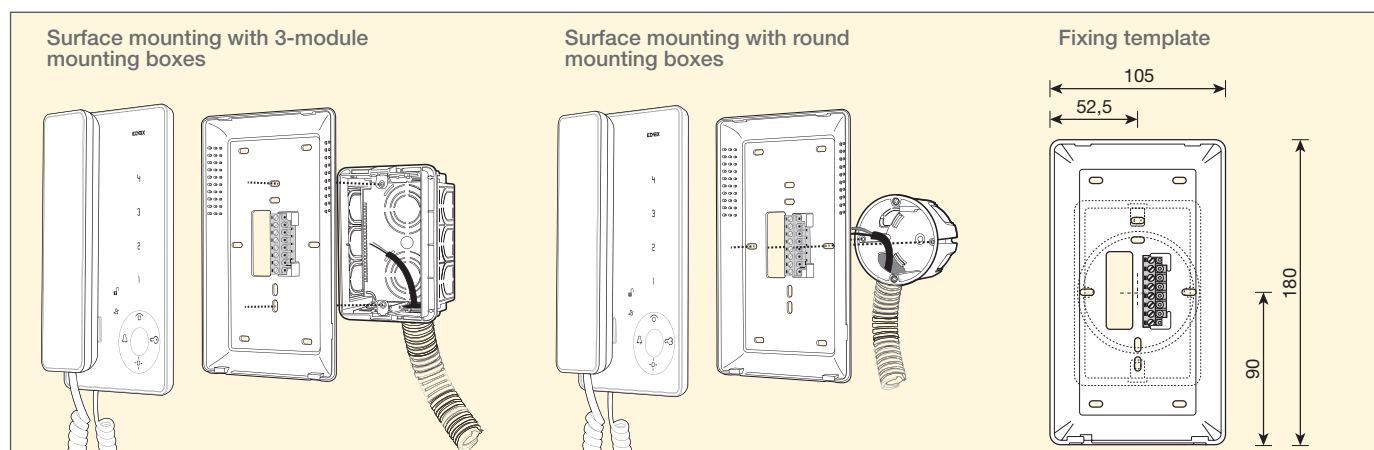

## Devices

### 6922 and 6922.1 - Power supply Due Fili Plus 30 Vdc

Main power supply for Due Fili Plus audio and video door entry systems. The power unit supplies simultaneously entrance panels, interphones, video door entry units and other devices when power limits exceeded, it is necessary to improve the system with 6923 supply unit for every devices added.

#### Conformity to standards

LV Directive, EMC Directive

Standards CEI 64-8 art 411.1.2.2, 2004/108/EC (6922)

Standards EN 50486 (6922.1)

#### Main technical specifications

- Electronic protection inside primary winding, not resettable.
- The power supply has two types of protection signalled by 2 LEDs, one green and one red.
- Housing in class UL-94 V0 technopolymer on 8-module DIN rail measuring 17.5 mm.
- Maximum overall dimensions: 140x115x65 mm.

Technical data	6922	6922.1
<b>Inputs</b>		
operating voltage	110 to 240 Vac 60 VA	110 to 240 Vac 60 W
rated current	260,9 mA	max 1 A (110 V), 0,6 A (240 V)
operating temperature	0 to +45° C	0 a +45° C
operating frequency	50/60 Hz	50/60 Hz
<b>Outputs</b>		
rated voltage	30 Vdc	30 Vdc
rated current	800+400 to 800+800 mA depending on input voltage *	1,6 A max (1 A in continuously + 0,6 intermittent 80 s for ON and 120 s for OFF)
available outputs	1,2 / B1,B2	1,2 / B1,B2

\*with 230 V a.c. 800 mA in continuous mode + 800mA

### 6923 - Additional Due Fili Plus power supply 28 V dc 15 VA

The additional power supply should be used in Due Fili Plus systems, to power electronic entrance panels and video door entry units, in support of the main power supply 6922 or 6922.1. The power supply is required when several video entrance panels are fitted and/or several video door entry units self-start simultaneously with the same call; the power supply can power a single specific device, entrance panel or video door entry unit.

#### Conformity to standards

LV Directive, EMC Directive

Standards 2006/95/EC LV, 2004/108/EC

#### Main technical specifications

- Output voltage with PTC protection for auxiliary services.
- PTC protection against short-circuits and overheating inside primary winding.
- Housing in class UL-94 V0 technopolymer on 4-module DIN rail measuring 17.5 mm.
- Maximum overall dimensions: 70x115x65 mm.

Technical data		
<b>Inputs</b>		
operating voltage	230 Vac	
rated current	65,2 mA	
operating temperature	+5° to +35° C	
operating frequency	50/60 Hz	
<b>Outputs</b>		
	- / +U	- / +I
rated voltage	26 Vdc	26 Vdc
rated current	0,5 A	0,5 A

### 69RS - Due Fili Plus Expansion interface

With the expansion interface, the number of internal units (audio and/or video door entry phones, etc.) can be increased from 200 to 6400. In the Due Fili Plus two-wire system, the Bus is split up into a horizontal Bus and multiple vertical Buses (32 max), with each vertical Bus connected to the horizontal Bus by way of a 69RS interface (one for each vertical bus).

Each vertical Bus (riser) allows the connection of up to:

- 200 internal units (audio and/or video door entry phones, telephone switchboards)
- 14 external units (electronic units, entrance panels and 69AM interfaces).
- 16 digital relays (8 x 69PH relay module).
- 1 x 945F switchboard.
- 1 level of 692S separators
- 6120 remote button modules.

Each horizontal bus (backbone) allows the connection of up to:

- 32 x 69RS expansion interface.
- 36 external units (16 video electronic units/69AM selectors and 20 audio electronic units).
- 100 digital relays (50 x 69PH relay module).

#### Conformity to standards

LV Directive, EMC Directive

Standard 2004/108/EC

#### Main technical specifications

- Housing ABS on 4-module DIN rail measuring 17.5 mm.
- Maximum overall dimensions: 72x110x60 mm.

Technical data	
<b>Inputs</b>	
power supply from Bus	28 Vdc rated voltage
operating temperature	0° to +40° C
available inputs	1
<b>Outputs</b>	
rated voltage	30 Vdc
available outputs	1
Power	1,5 W
Minimum absorption on backbone Bus	15 mA
Maximum absorption on backbone Bus	40 mA
Minimum absorption on riser Bus	25 mA
Maximum absorption on riser Bus	50 mA



## Devices

### Due Fili Plus power supply

<b>6922</b>	Power supply unit for video door entry system with 30 Vdc output, power supply 110-240 V~ 50/60 Hz 60 VA, installation on DIN rail (60715 TH35), occupies 8 modules of 17.5 mm
<b>▲ 6922.1</b>	Power supply unit for video door entry system with 30 Vdc output, power supply 110-240 V~ 50/60 Hz, installation on DIN rail (60715 TH35), occupies 8 modules of 17.5 mm

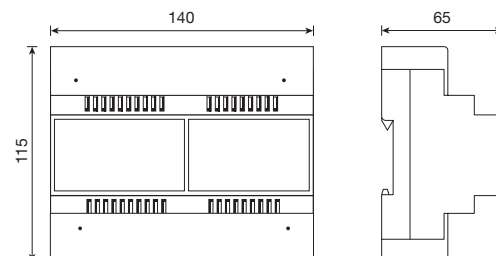

**6922**  
**▲ 6922.1**

### Due Fili Plus additional power supply

<b>6923</b>	Additional power supply unit for system video door entry system with 28 Vdc output, power supply 230 V~ 50 Hz 15 VA, installation on DIN rail (60715 TH35), occupies 4 modules of 17.5 mm
-------------	---

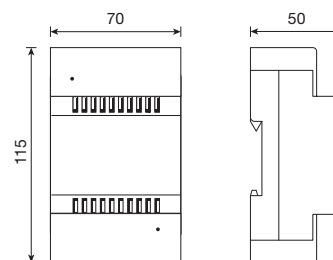

**6923**

### Due Fili Plus Expansion interface

<b>69RS</b>	Expansion interface for the management of up to 200 internal units in Due Fili Plus systems. The use of several 69RS devices allows connection of up to 6400 internal units in the same system, installation on DIN rail (60715 TH35), occupies 4 modules of 17.5 mm
-------------	--

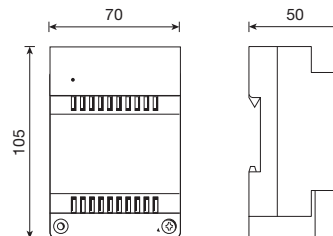

**69RS**

## Devices

### 692S - Due Fili Plus separator

The device is an accessory used in Due Fili Plus systems to create separate communication islands, and must be used with 6922 or 6922.1. It should be used in the following cases:

- in systems for building complexes, in which there are one or more main entrance panels, one or more buildings with one or more secondary entrance panels inside. One separator for each building;
- in systems where landing entrance panels are connected to the audio or video door entry unit. One separator for each landing entrance panel;
- in systems with intercommunicating audio and video door entry units, which should not require the communication of other devices during a conversation;
- a maximum of 16 separators can be installed in the system;
- the device is programmed via suitable configurers (jumpers) that are supplied.

### Conformity to standards

EMC Directive

Standards 61000-6-1, EN 61000-6-3

### 69DV - Due Fili Plus risers splitter

The splitter is used to divide the riser (with audio and video door entry units), creating up to 4 distinct risers.

Splitters can be connected in cascade — no more than 2 — so as to divide the riser into 8 sections.

### Conformity to standards

EMC Directive

Standards 61000-6-1, EN 61000-6-3

### Main technical specifications

- Housing ABS on 4-module DIN rail measuring 17.5 mm.
- Maximum overall dimensions: 72x110x60 mm.

### 69MX and 69MX/5 - Due Fili Plus concentrators

The concentrator is used to connect multiple external entrance panels (including one video entrance panel) in parallel. The concentrator has 4 inputs for 4 entrance panels, and 2 outputs for the riser; to increase the number of entrance panels in parallel, multiple concentrators can be connected in series or in cascade (up to a maximum of 16 entrance panels).

### Conformity to standards

EMC Directive

Standards 61000-6-1, EN 61000-6-3

### Main technical specifications

- Housing ABS on 4-module DIN rail measuring 17.5 mm.
- Maximum overall dimensions: 72x110x60 mm.

### Main technical specifications

- Housing ABS on 4-module DIN rail measuring 17.5 mm
- Maximum overall dimensions: 70x105x50 mm.

#### Technical data

Inputs	
power supply from primary Bus	28 Vdc rated voltage
minimum absorption from primary Bus	15 mA
maximum absorption from primary Bus	40 mA
power supply from secondary Bus	
minimum absorption from secondary Bus	25 mA
maximum absorption from primary Bus	50 mA
operating temperature	0° to +40° C

#### Technical data

Inputs	
power supply from Bus	28 Vdc rated voltage
operating temperature	0° to +40° C
available inputs	1
Outputs	
rated voltage	30 Vdc
rated current	15 mA
available outputs	5
Power	4,5 W
Absorption in stand-by	15 mA
Max absorption operation	50 mA

\* Maximum current between OUT 1, OUT 2, OUT3, OUT4 = 1,5 A

#### Technical data

Inputs	
power supply from Bus	28 Vdc rated voltage
operating temperature	0° to +40° C
available inputs	4
Outputs	
rated voltage	30 Vdc
available outputs	2
Power	1,5 W
Absorption stand-by	25 mA
Max absorption operation	50 mA
Maximum current between OUT 1 and OUT 2	1,5 A
Maximum current between OUT 1 and IN 1	0,8 A
Maximum current between OUT 1 and IN 2	0,8 A
Maximum current between OUT 1 and IN 3	0,8 A
Maximum current between OUT 1 and IN 4	0,8 A

## Devices

### Due Fili Plus separator

<b>692S</b>	Separator for dividing conversation areas, for use with intercom networks, entrance panels for door calls and building complexes, installation on DIN (60715 TH35), occupies 4 modules of 17.5 mm
-------------	---



692S

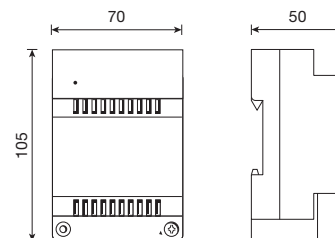

### Due Fili Plus risers splitter

<b>69DV</b>	Riser splitter, for dividing the bus into 4 riser lines, installation on DIN rail (60715 TH35), occupies 4 modules of 17.5 mm
▲ <b>69DV/5</b>	As above, for cat. 5 system



69DV  
▲ 69DV/5

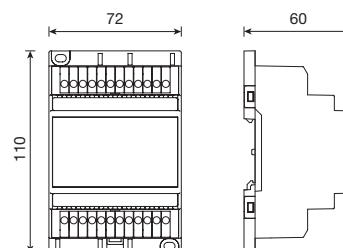

### Due Fili Plus concentrators

<b>69MX</b>	Concentrator for the connection of up to 4 entrance panels in parallel per module, at least one of which is a video entrance panel, installation on DIN rail (60715 TH35), occupies 4 modules of 17.5 mm
<b>69MX/5</b>	As above, for cat. 5 system



69MX  
69MX/5

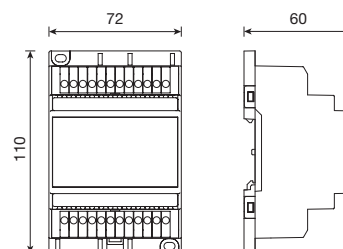

## Devices

### 692D - Due Fili Plus passive video distributor

The passive video distributor is a device allowing the simultaneous distribution of video signal over several separate outputs. It is used, for example, when a call signal needs to be transmitted to several video door entry units simultaneously (star connection).

#### Conformity to standards

EMC Directive  
Standards EN 61000-6-1, EN 61000-6-3

#### Main technical specifications

- Housing ABS on 1-module DIN rail measuring 17.5 mm.
- Maximum overall dimensions: 60x82x21 mm.

### 692D/2 - Due Fili Plus active video distributor

The active video distributor is a device that can amplify an incoming signal and make it available over several separate outputs; in practice it distributes the signal to a specific number of destinations simultaneously. It is used, for example, when a call signal needs to be transmitted to several video door entry units simultaneously (star connection).

#### Conformity to standards

EMC Directive  
Standards EN 61000-6-1, EN 61000-6-3

#### Main technical specifications

- Housing ABS on 4-module DIN rail measuring 17.5 mm.
- Maximum overall dimensions: 70x115x50 mm.

### 69PH - Due Fili Plus digital actuator, 2 outputs

A programmable device with two independent relays operating with separate or correlated programming. It can be programmed manually for standard functions or using the programmer art. 950C or SaveProg software for advanced functions. In standard operation it can be used as a one-position stable relay (default configuration) or call repeater (after programming). The relays on module 69PH can be activated by audio/video door entry unit push buttons or by a call from an outdoor entrance panel, intercommunicating audio/video door entry unit, porter switchboard or push button module art. 6120.

#### Conformity to standards

LV Directive, EMC Directive  
Standards EN 60065, EN 61000-6-1, EN 61000-6-3

#### Main technical specifications

- Maximum load across contacts (terminals 1C/NO/NC, 2C/NO/NC): 230 V 6 A / AC1 (resistive or weak inductive load).
- Due Fili Plus Bus power supply.

#### Technical data

Inputs	
power supply from Bus	28 Vdc rated voltage
rated current	0
operating temperature	0° to +40° C
IP degree	20
available inputs	1
Outputs	
available outputs	4

#### Jumper positions

For signal level regulation

- position **H**: high level
- position **M**: medium level
- position **L**: low level

For Bus termination

- position **A**: no termination
- position **B**: termination 100 Ohm
- position **C**: termination 50 Ohm

#### Technical data

Inputs	
power supply from Bus	28 Vdc rated voltage
absorption stand-by	13 mA
max absorption operation	30 mA
operating temperature	0° to +40° C
IP degree	20
available inputs	1
Outputs	
available outputs	4

- Absorption: 1.8 mA in standby, 15 mA in operation, 80 mA for 80 ms peak current.
- Operating temperature: 0 - 40°C
- For DIN rail (60716 TH35) rail installation sized 17.5 mm.
- Maximum overall dimensions 70x115x50 mm.

#### Technical data

Inputs	
operating voltage	28 Vdc rated voltage
current draw in stand-by	1,8 mA
min absorption operation	15 mA
max absorption operation	80 mA
operating temperature	0° to +40° C
IP degree	20
Outputs	
rated voltage	230 V
rated current	6 A
contact rating	6 A
available outputs	2

## Devices

### Due Fili Plus video distributor

<b>692D</b>	Passive floor distributor for adapting video signal impedance on balanced connection lines, installation on DIN rail (60715 TH35), occupies 1 module of 17.5 mm
<b>692D/2</b>	Active floor distributor for adapting video signal impedance on balanced connection lines, installation on DIN rail (60715 TH35), occupies 4 modules of 17.5 mm



692D

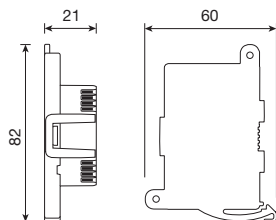

692D/2

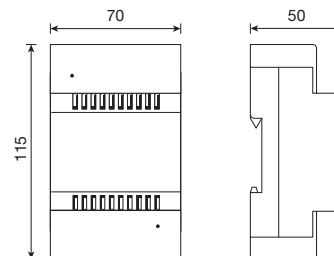

### Due Fili Plus digital actuator

<b>69PH</b>	Programmable device with 2 x 6 A 230 V- change-over relays operating in line with separate or correlated programming, can be programmed manually for standard functions and using programmer 950C or SaveProg software for advanced functions, in standard operation it can be used as a monostable relay or call repeater, installation on DIN rail (60715 TH35), occupies 4 modules of 17.5 mm
-------------	--



69PH

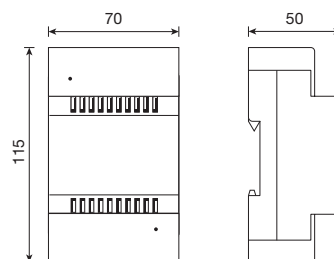

## Installation examples

### Due Fili Plus video door entry system with one outdoor entrance panel and several indoor video door entry units

The example shows a Due Fili Plus video door entry system in a residential setting with one outdoor entrance panel connected to several indoor video door entry units, with an independent video door entry unit/video door entry unit and video door entry unit/interphone intercom network.

#### Example with video distributor

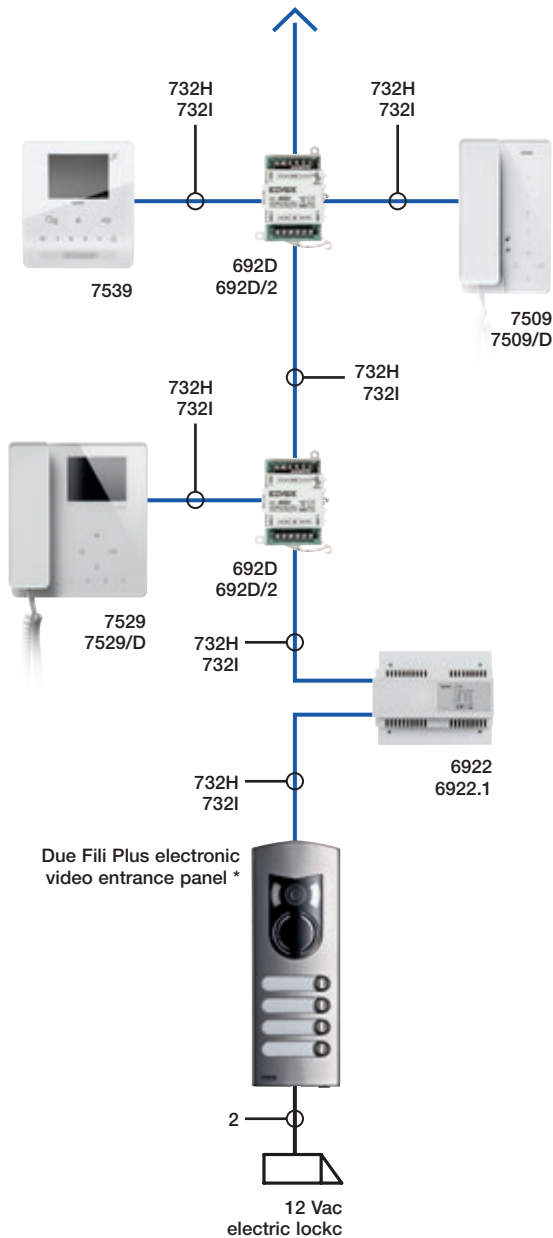

#### Example for enter/exit system

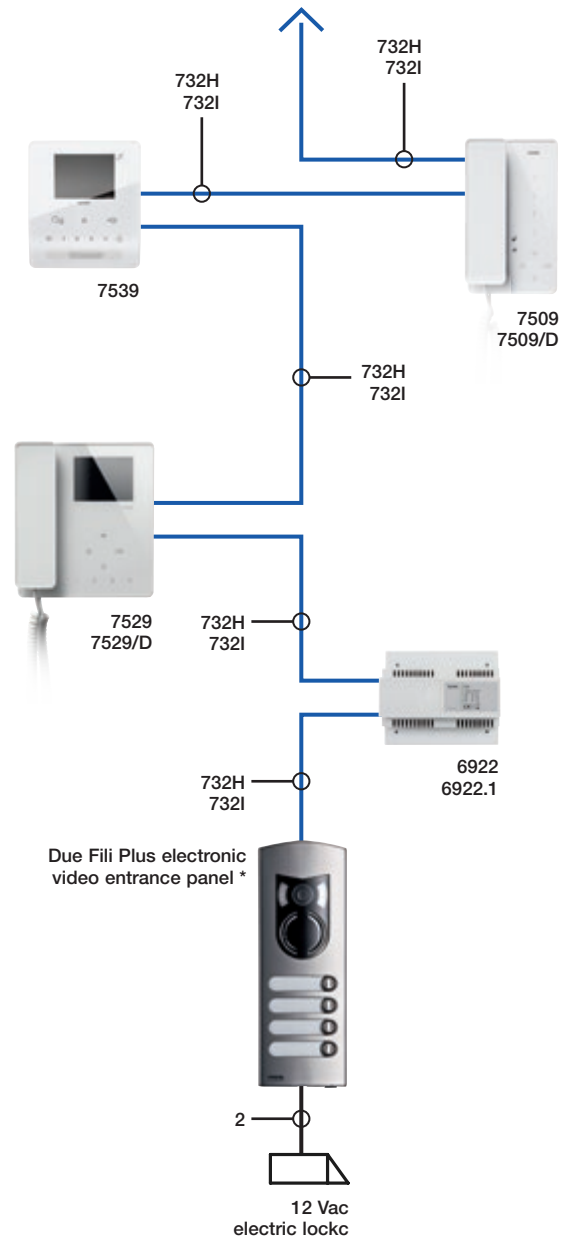

\* Series: 1200, 1300, 8000, Post Box, Inox Flat, Patavium, Letter Box

## Installation examples

### Due Fili Plus audio door entry system with one outdoor entrance panel and several indoor interphones

The examples show a Due Fili Plus audio door entry system in a residential setting with one outdoor entrance panel connected to several indoor interphones. All interphones are intercommunicating with one another and calls from the outdoor entrance panel have priority over all other calls in progress.

#### Example with star connection

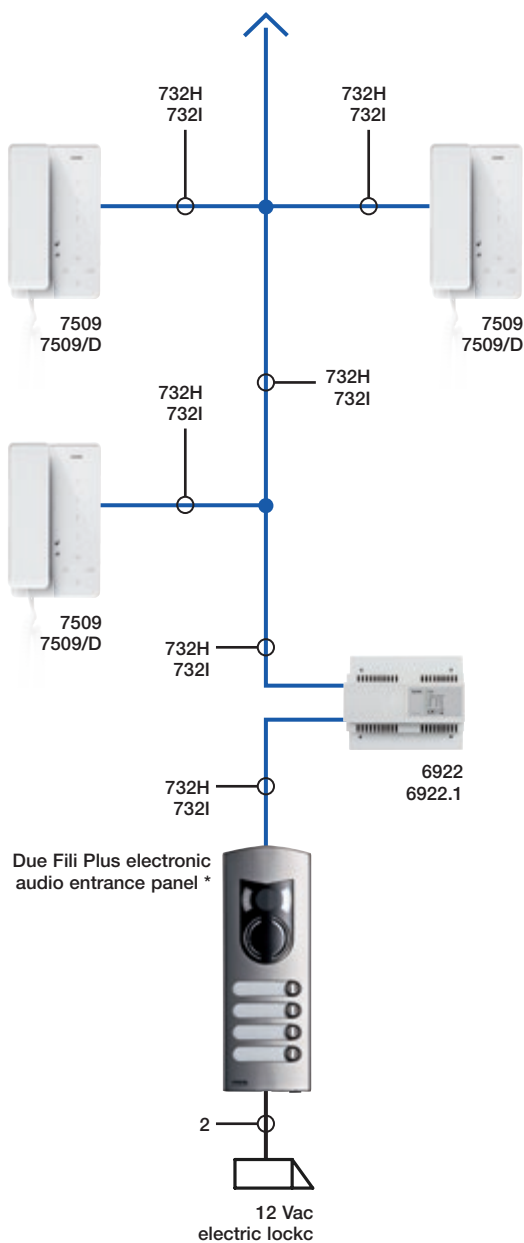

#### Example for enter/exit system

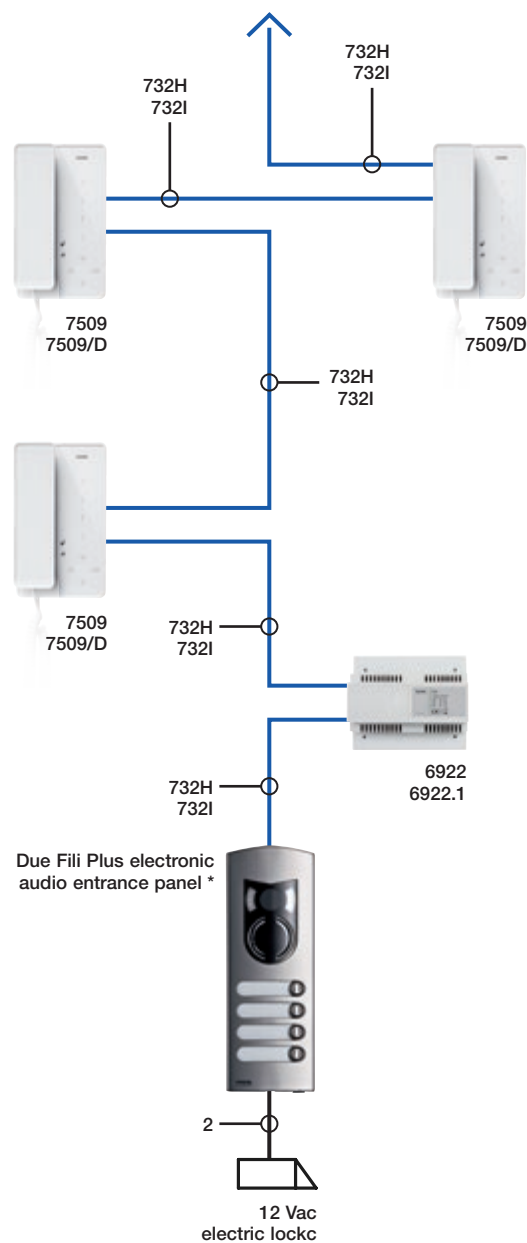

\* Series: 1200, 1300, 8000, Post Box, Inox Flat, Patavium, Letter Box

## Installation examples

### Due Fili Plus video door entry system with one outdoor entrance panel and independent intercom network

The example shows a Due Fili Plus video door entry system in a residential setting with one outdoor entrance panel connected to several indoor video door entry units, with an independent video door entry unit/video door entry unit and video door entry unit/interphone intercom network.

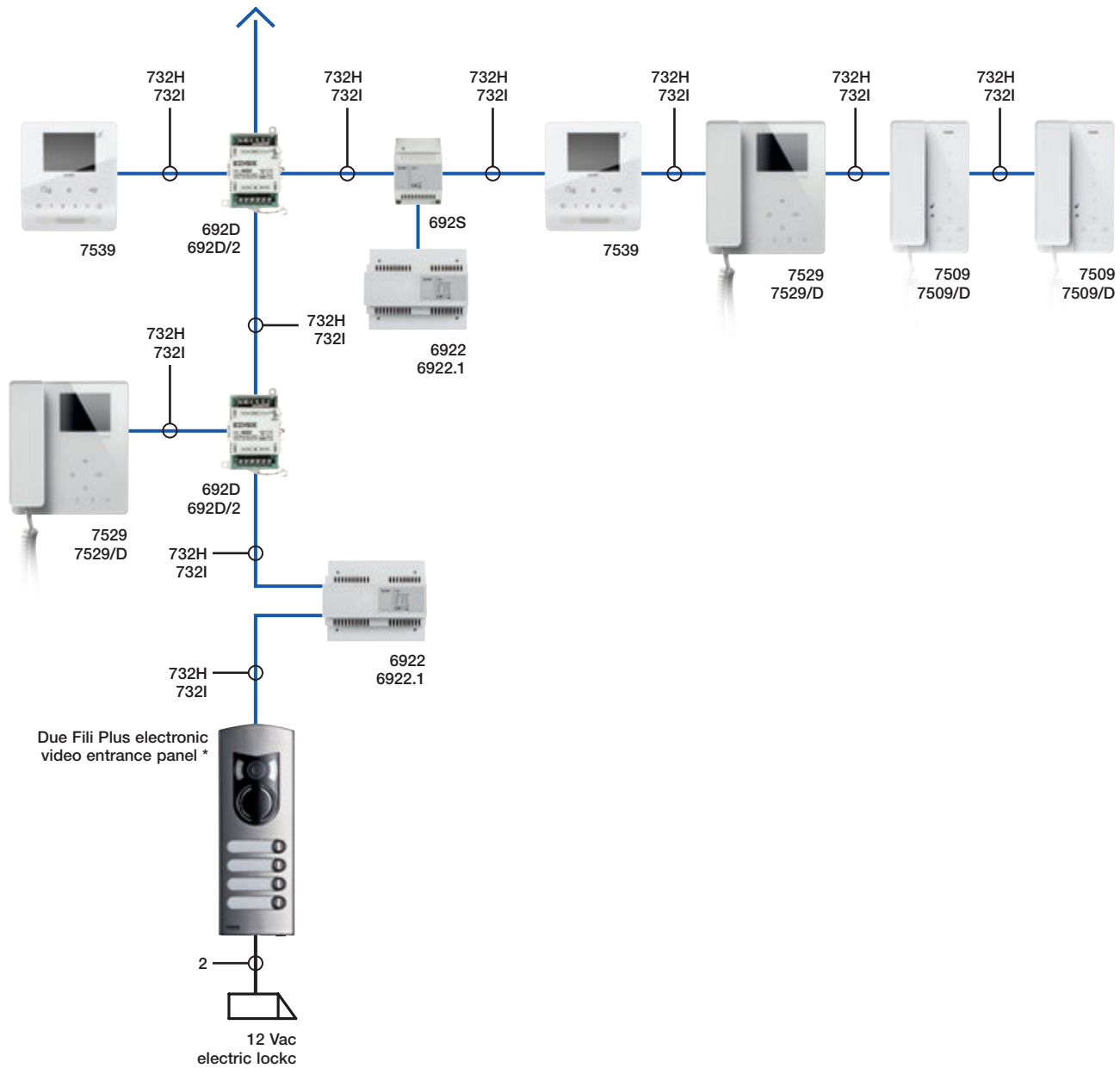

\* Series: 1200, 1300, 8000, Post Box, Inox Flat, Patavium, Letter Box



## Installation examples

### Due Fili Plus audio door entry system with one outdoor entrance panel and independent intercom network

The example shows a Due Fili Plus audio door entry system in a residential setting with one outdoor entrance panel connected to several indoor interphones, with an independent interphone/interphone intercom network.

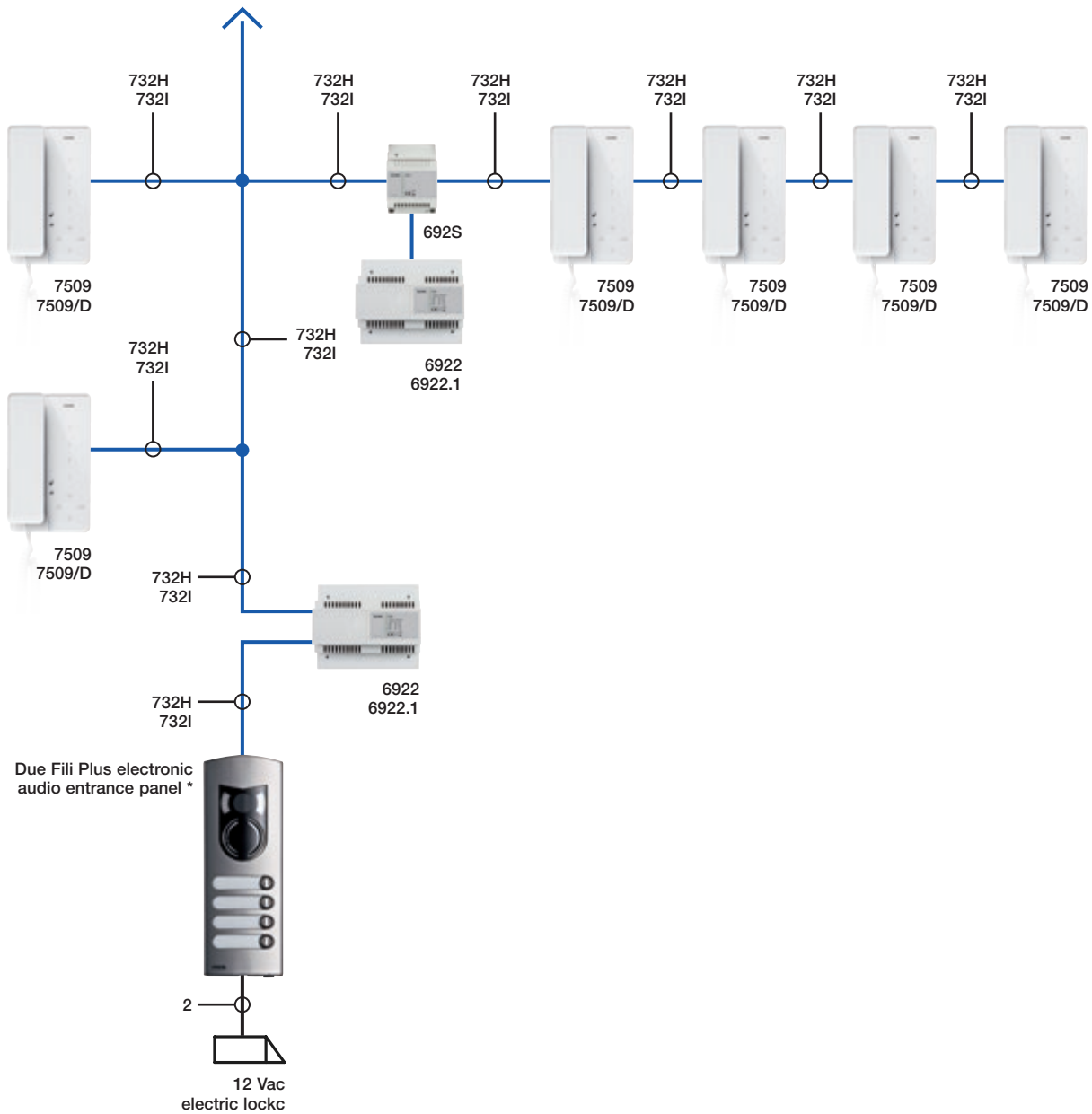

\* Series: 1200, 1300, 8000, Post Box, Inox Flat, Patavium, Letter Box





B-C14007 EN 1401  
8 013406 254977



Viale Vicenza, 14  
36063 Marostica VI - Italy  
Tel. +39 0424 488 600  
Fax +39 0424 488 188  
www.vimar.com 